

# ASSEMBLY INSTRUCTIONS

## Wooden Drawer / Trash Can for TB18 (NOT including TB18 & 1/8" Drill Bit)

### KIT PARTS LIST

**A-Drawer Front(1) B-Drawer Sides(2) C-Drawer Rear(1) E-Slides(1 pair)**  
**F-Trash can(1 pair)**

### HARDWARE PARTS LIST

**6-Screw(Φ 4\*25-8pcs) 7-Screw(Φ 3.5\*16-10pcs) 8-Screw(Φ 3.5\*12-16pcs) 9-L shape Metal(2 pairs)**

Step1: Connect (A) with (B) using glue. Step2: Connect (C) with (B) using glue. Step3: Connect using 6-screws(4pcs).

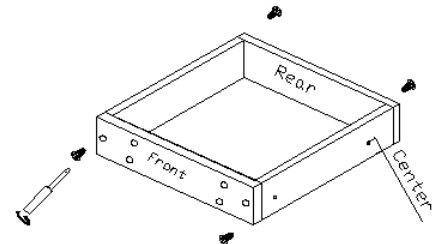
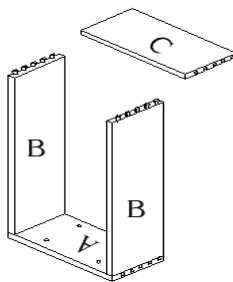
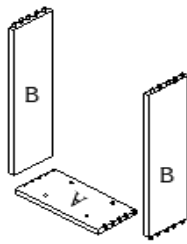

Step4: Mount short parts of (E) on each (B).  
using 7-screws(4pcs).

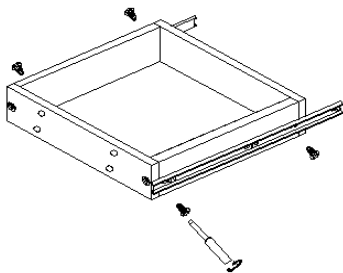

Step5: Connect Drawer to Door.  
using 6-screws(4pcs).

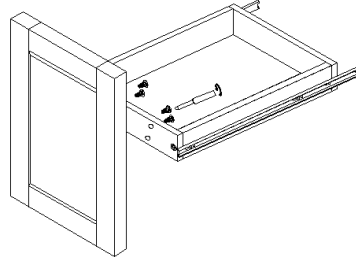

Step6: Mount (9)-L shape metal on  
Door & Drawer, using 8-screws(16pcs).

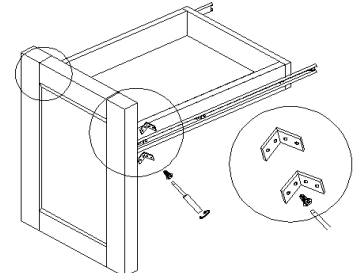

Step7: **Must Predrill the Pilot Hole (1/4" Depth or less)**  
on Face Frame of TB18. (Recommend 1/8" drill bit)

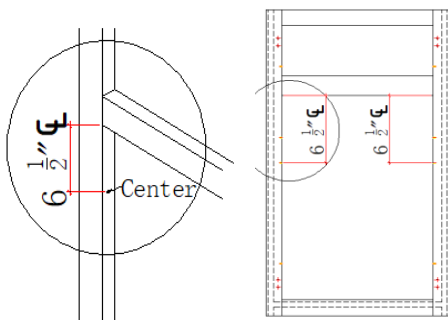

Step8-1: Mount long parts of (E) on Face Frame and 8-2: Mount  
Rear Brackets of (E) on Back Panel, using 7-screws(4pcs).

**Must be on Horizontal line**

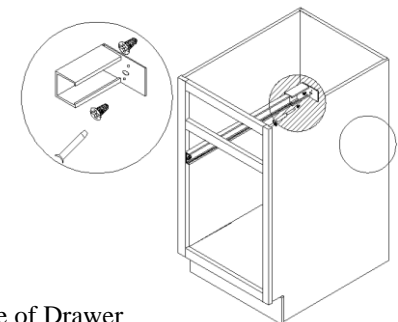
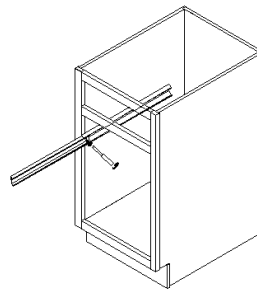

Step9: Connect two parts of (E) slide together

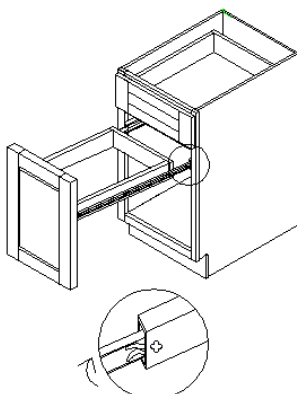

Step10: Put (F) inside of Drawer

